

Digital Grand Piano

Owner's Manual

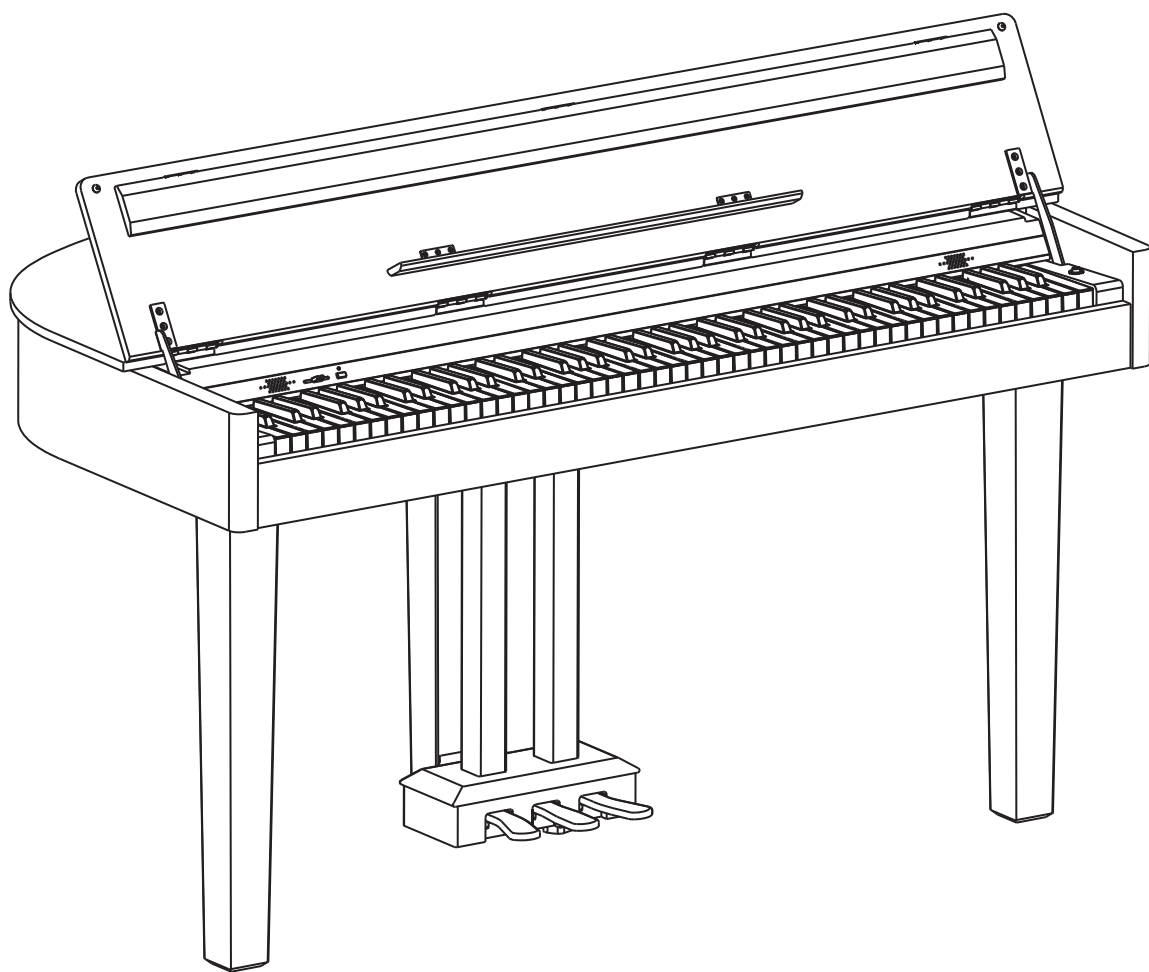

INFORMATION FOR YOUR SAFETY!

THE FCC REGULATION WARNING (for USA)

This equipment has been tested and found to comply with the limits for a Class B digital device, pursuant to Part 15 of the FCC Rules.

These limits are designed to provide reasonable protection against harmful interference in a residential installation. This equipment generates, uses, and can radiate radio frequency energy and, if not installed and used in accordance with the instructions, may cause harmful interference to radio communications. However, there is no guarantee that interference will not occur in a particular installation. If this equipment does cause harmful interference to radio or television reception, which can be determined by turning the equipment off and on, the user is encouraged to try to correct the interference by one or more of the following measures:

- Reorient or relocate the receiving antenna.
- Increase the separation between the equipment and receiver.
- Connect the equipment into an outlet on a circuit different from that to which the receiver is connected.
- Consult the dealer or an experienced radio/TV technician for help.

Unauthorized changes or modification to this system can void the user's authority to operate this equipment.

CAUTION

The normal function of the product may be disturbed by Strong Electro Magnetic Interference. If so, simply reset the product to resume normal operation by following the owner's manual. In case the function could not resume, please use the product in other location.

PRECAUTIONS

PLEASE READ CAREFULLY BEFORE PROCEEDING

Please keep this manual in a safe place for future reference.

Power Supply

Please connect the designated AC adaptor to an AC outlet of the correct voltage.

Do not connect it to an AC outlet of voltage other than that for which your instrument is intended.

Unplug the AC power adaptor when not using the instrument, or during electrical storms.

Connections

Before connecting the instrument to other devices, turn off the power to all units. This will help prevent malfunction and / or damage to other devices.

Location

Do not expose the instrument to the following conditions to avoid deformation, discoloration, or more serious damage:

Direct sunlight
Extreme temperature or humidity
Excessive dusty or dirty location
Strong vibrations or shocks
Close to magnetic fields

Interference with other electrical devices

Radios and televisions placed nearby may experience reception interference. Operate this unit at a suitable distance from radios and televisions.

Cleaning

Clean only with a soft, dry cloth.
Do not use paint thinners, solvents, cleaning fluids, or chemical-impregnated wiping cloths.

Handling

Do not apply excessive force to the switches or controls.

Do not let paper, metallic, or other objects get into the instrument. If this happens, remove the electric plug from the outlet. Then have the instrument inspected by qualified service personnel.

Disconnect all cables before moving the instrument.

Panel Description

Front Panel.....	4
Rear Panel.....	5

Setup

Part List.....	6
Setup Guide.....	6
Power Supply.....	9

Connections

Connecting a pair of Headphones.....	10
Connecting an Audio Equipment.....	10
Connecting an MP3/CD Player.....	10
Connecting a Computer and an MIDI.....	10

Playing to the Demo song.....	11
-------------------------------	----

Adjusting the Volume.....	11
---------------------------	----

Playing Voices

Selecting a Voice.....	12
Playing two Voices Simultaneously.....	12
Playing a Lower Voice.....	12
Playing Voice Demo.....	13
Touch Response.....	13

Digital Effects

Reverb and Chorus.....	14
EQ Effect.....	14

Metronome.....	15
----------------	----

Tempo.....	16
------------	----

BeepTone.....	16
---------------	----

Troubleshooting.....	17
----------------------	----

Specifications.....	17
---------------------	----

Appendices

Voice List.....	18
MIDI Implementation List chart.....	19

Panel Description

Front Panel

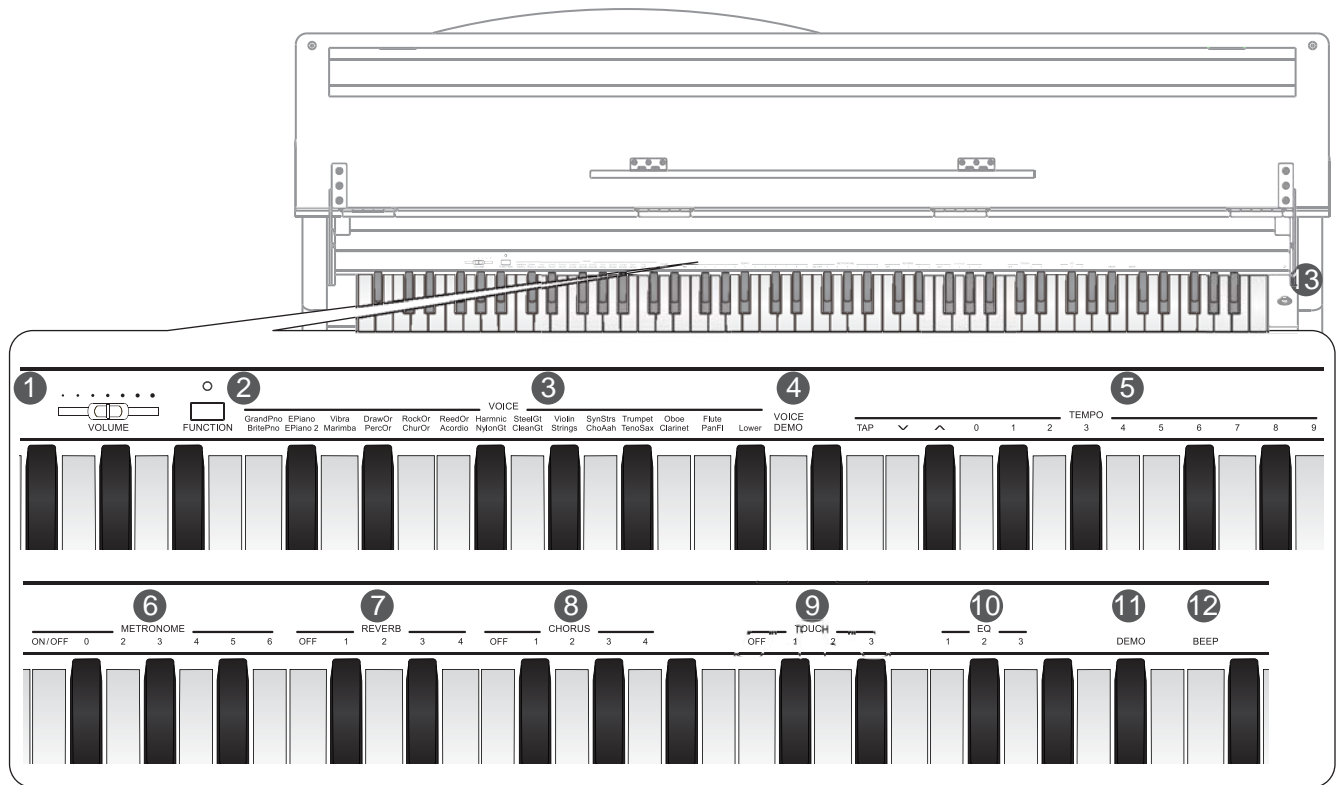

1. [VOLUME] slider

Adjust the master volume.

2. [FUNCTION] button

Press and hold it to access secondary functions of the keys on the keyboard.

3. VOICE SELECT Keys

Hold down the [FUNCTION] button and press the keys to select a voice.

4. VOICE DEMO Key

Hold down the [FUNCTION] button and press the key to start or stop the voice demo playing.

5. TEMPO ADJUST Keys

Hold down the [FUNCTION] button and press the keys to adjust the current tempo.

6. METRONOME Keys

Hold down the [FUNCTION] button and press the [ON/OFF] key to turn the metronome ON or OFF. Hold down the [FUNCTION] button and press the other keys to select the time signature.

7. REVERB Keys

Hold down the [FUNCTION] button and press the [ON/OFF] key to turn reverb effect ON or OFF. Hold down the [FUNCTION] button and press the other keys to select the reverb type.

8. CHORUS Keys

Hold down the [FUNCTION] button and press the [ON/OFF] key to turn chorus effect ON or OFF. Hold down the [FUNCTION] button and press the other keys to select the chorus type.

9. TOUCH Keys

Hold down the [FUNCTION] button and press the keys to select different touch response level.

10. EQ Keys

Hold down the [FUNCTION] button and press the keys to select the EQ type.

11. DEMO Keys

Hold down the [FUNCTION] button and press the key to start or stop playing the demo song.

12. BEEP Key

Hold down the [FUNCTION] button and press the key to turn the "setting change" tone ON or OFF.

13. [POWER] button

Turn the power ON or OFF.

14. Soft Pedal

When the soft pedal is pressed, all notes played on the keyboard will have a softer effect.

15. Sostenuto Pedal

When the sostenuto pedal is pressed, the notes played before you step on the pedal will have a sustain effect.

16. Sustain Pedal

When the sustain pedal is pressed, all notes played on the keyboard will have a longer sustain.

It also supports the half-pedal operation, which makes your sustain effect more smooth and real when you are performing.

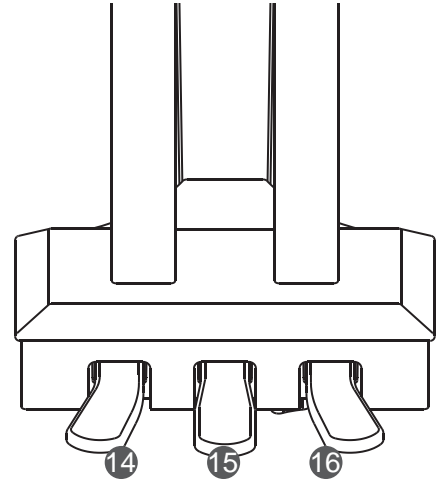

Rear Panel

17. USB Jack

Connect to a computer.

18. MIDI OUT Jack

Connect to the MIDI IN jack of external MIDI device.

19. MIDI IN Jack

Connect to the MIDI OUT jack of external MIDI device.

20. AUX OUT Jack

Connect the audio equipment.

21. AUX IN Jack

Connect an external sound source, such as an MP3 or CD player.

22. DC IN Jack

Connect the DC power adaptor.

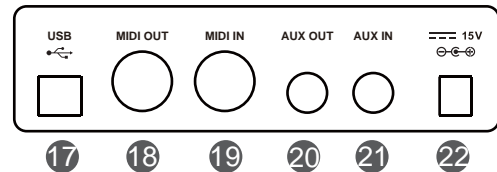

Setup

In addition to the main piano cabinet, your Grand200 should come with the parts shown below. Three people will be need to complete the assembly, as the piano cabinet must first rest on the floor with support. Then the entire instrument must be lifted once the legs are securely attached.

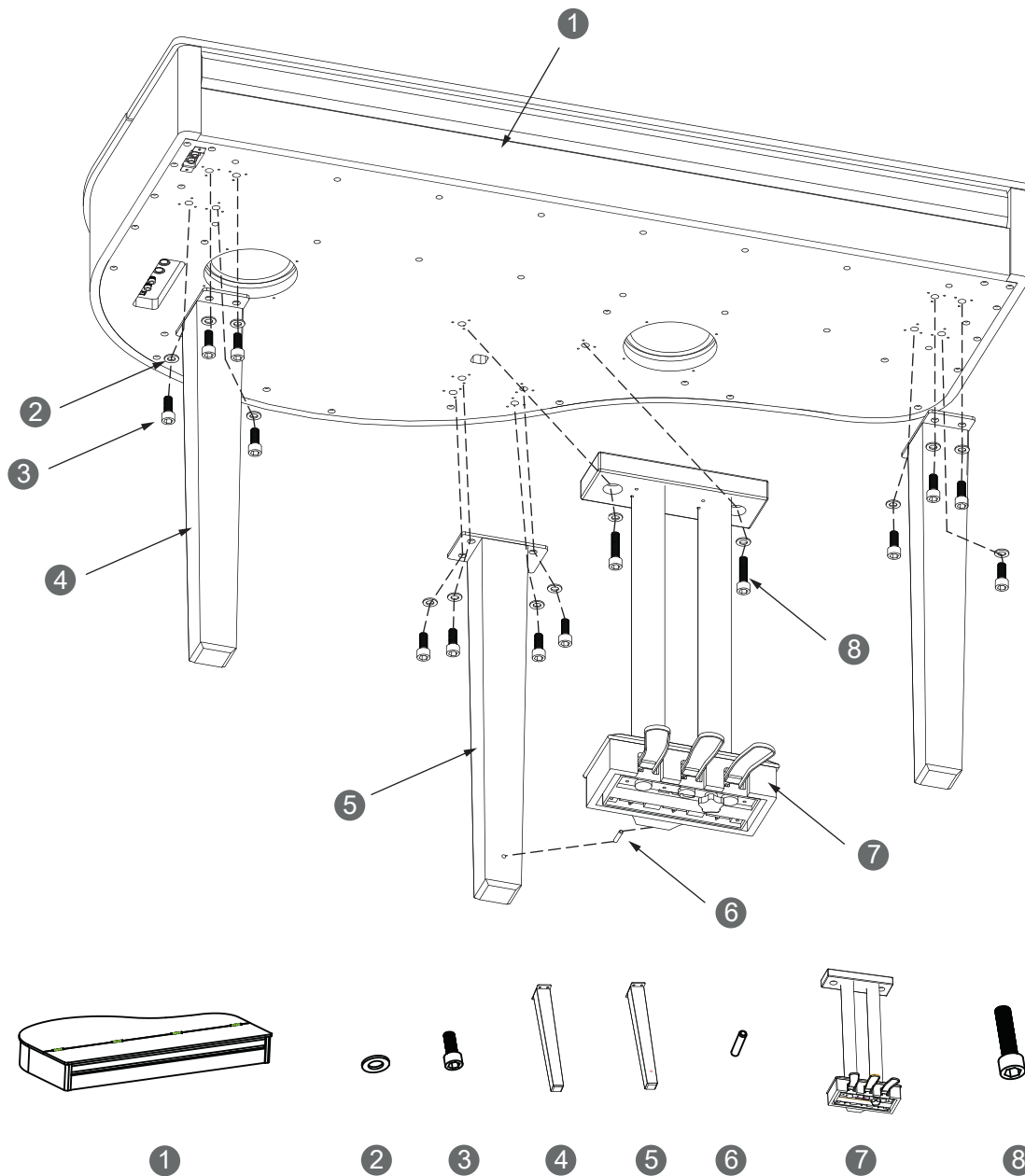

No.	Component Name	Quantity
1	The Piano	1
2	Washer	14
3	M6x25 hexagon bolt	12
4	Left and right legs	2
5	Rear leg	1
6	Wood dowel	1
7	The pedal leg	1
8	M6x40 hexagon bolt	2

1. Place the left, the right and the rear legs ④ & ⑤ as shown in the picture, and then fix the legs with the M6x25 hexagon bolts ③ and the washers ②, tighten with a Hex key (not included).

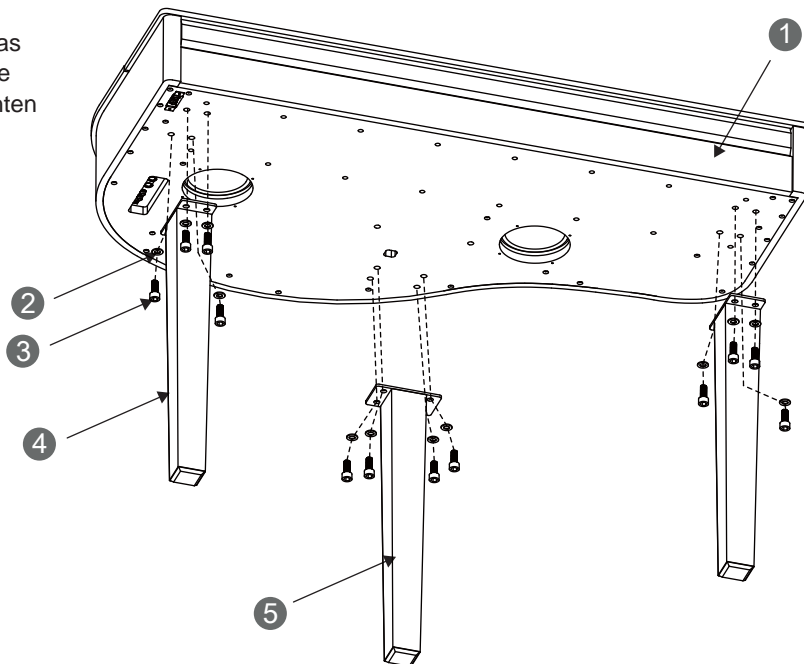

2. Plug the wood dowel ⑥ into the rear leg ⑤.

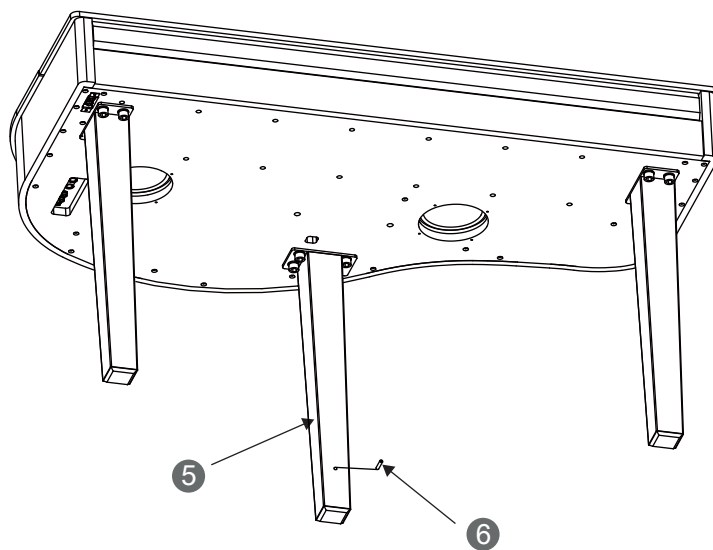

Setup

3. Place the pedal leg ⑦ as shown in the picture, and then fix the leg with the M6X40 hexagon bolts ⑧ and the washers ②, tighten with a Hex key .

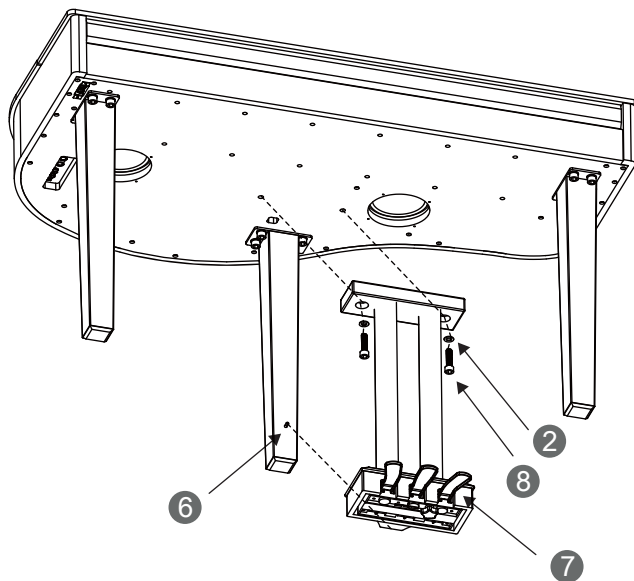

4. Put the pedal assembly line on the plug body pedal jack.

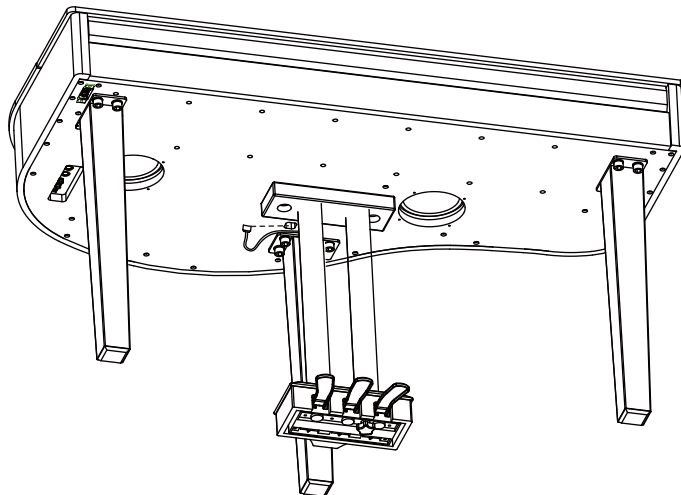

5. Move the piano into an upright position. Using 3 people, one near each leg, lift the piano body straight upward with legs parallel to the floor. Then tilt backward until all 3 legs are vertical. Finally, lower the body until the legs touch the floor.

To avoid possible damage, don't let the weight of the body rest on the legs until they are vertical.

WARNING:

The piano cabinet will not safely sit unsupported on the legs until all of the bolts are in place. Have an assistant hold the cabinet while the bolts are being secured.

Power Supply

1. Make sure that the piano is turned off. Before you switch your piano on or off, turn down the volume of piano and any connected audio equipments first.

2. Connect the AC adaptor to the DC IN jack.

3. Plug the AC adaptor into an AC outlet.

4. Press the [POWER] button, the LED display lights up, that indicates the piano is powered on.

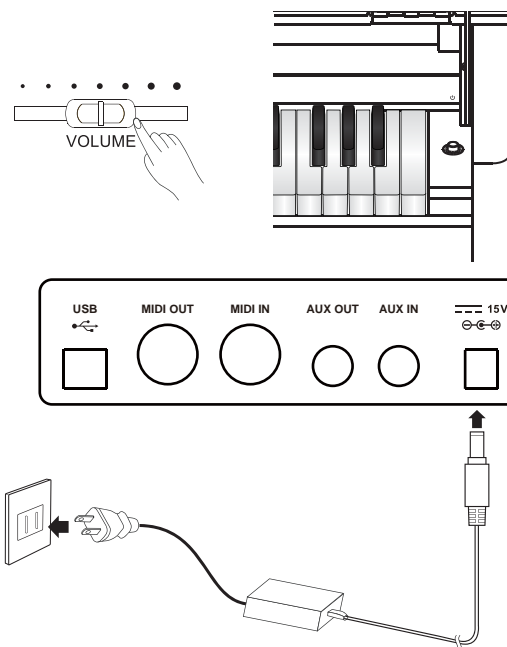

Note:

- In order to save energy, we have designed the "Automatic Shutdown" function. The piano will automatically shut down after 30 minutes if it is not used. To turn off the function, press and hold [A0] key (the 1st key on the keyboard), then turn on the power.
- When the piano is not in use or during thunderstorm, please disconnect the power for safety purpose.

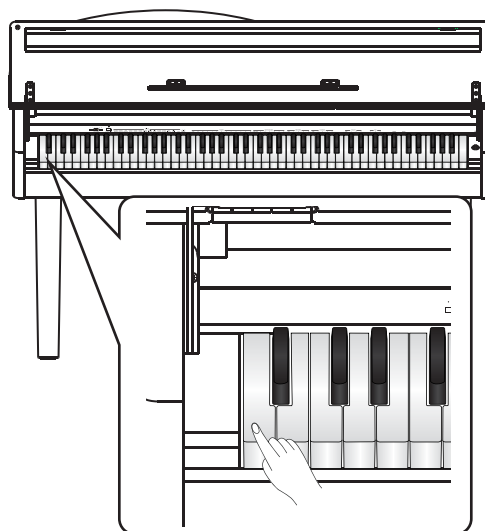

Connections

Connecting a pair of Headphones

A standard pair of stereo headphones can be plugged in here for private practice or late-night playing.

Jack1: When a pair of headphones is plugged into Jack 1, the sound can be heard from headphones and speakers of the instrument.

Jack2: When a pair of headphones is plugged into Jack 2, the internal stereo speaker system is automatically shut off. The sound can be heard from headphones.

Note:

Do not listen with the headphones at high volume for long periods of time. Doing so may cause hearing loss.

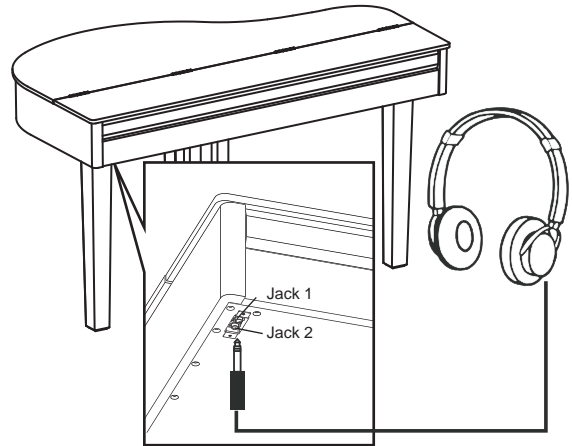

Connecting an Audio Equipment

The rear-panel AUX OUT jack delivers the output of the instrument to a keyboard amplifier, stereo sound system, a mixing console, or tape recorder. Use an audio cord to connect the AUX OUT jack on the rear panel to the AUX IN jack of the amplifier.

Note:

To avoid damaging the speakers, set the volume level to minimum before connecting the power and other devices.

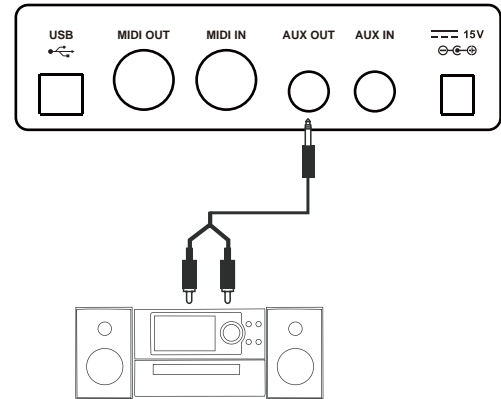

Connecting an MP3/CD Player

Connect the audio output of an MP3/CD player or other audio source to the stereo AUX IN jack on the rear panel.

The input signal is mixed with the piano signal, allowing you to play along.

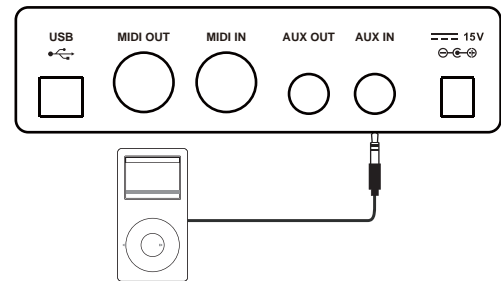

Connecting a Computer and an MIDI

MIDI OUT Jack

Connect the MIDI OUT jack to the MIDI IN jack of external MIDI device with a MIDI cable.

The piano will control the external device by transmitting MIDI messages to it.

MIDI IN Jack

Connect the MIDI IN jack to the MIDI OUT jack of external MIDI device with a MIDI cable.

The piano will receive MIDI messages from the external device and work as a sound source.

USB Jack

Connect the USB jack to a PC with a USB cable, and you can transfer data between the piano and the PC.

Note:

Do not set the USB device to be input and output simultaneously when you are setting the software on the computer. Otherwise the sound will be overlapped when playing the keyboard.

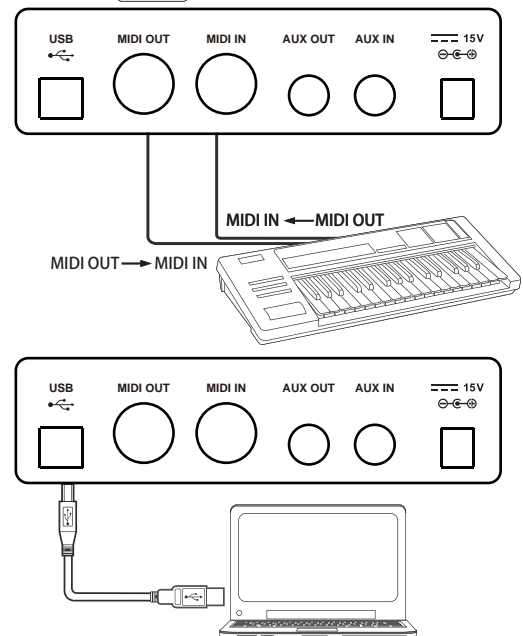

Playing the Demo Song

While holding down the [FUNCTION] button, press DEMO key to start the demo song playing.
Repeat the operation to stop the demo playback.

Note:

During demo playback, all other keys on the keyboard become invalid.

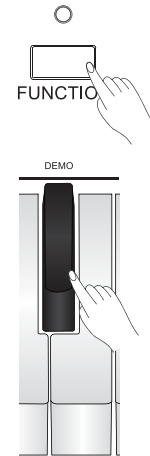

Adjusting the Master Volume

Move the [VOLUME] slider rightwards, the volume increases. Moving it leftwards will turn the volume down.

Note:

If the keyboard keeps silent, check if the volume has been set to minimum, or if headphones have been plugged into Jack 2.

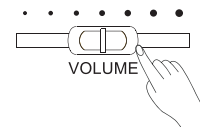

Playing Voices

Playing a Voice

The instrument features 26 exceptionally realistic voices. Please refer to Voice List.

1. While holding down the [FUNCTION] button, press one of the VOICE SELECT keys to select a desired voice.
2. Play the keyboard and enjoy the wonderful voice.

Note:

1. Each key has two preset voices. Press a key once to select the first voice, press it again to select the second voice. Press the key repeatedly to shift between the first and second voices.
2. In voice selection, it will select the voice from the same layer when you press once another voice key. For example, if you have selected the second voice of a key, and you only need to press once another key, it will select the second voice of that key. It works the same with the first voice of the keys.

3. While voice is selected, the dual voice and lower voice will be turned off automatically.

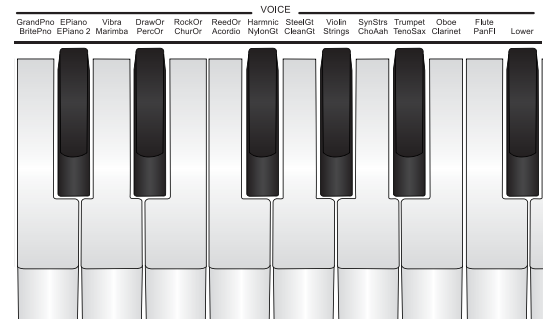
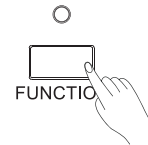

Playing two Voices Simultaneously - DUAL

The dual function allows two different voices to be layered together, creating a much richer sound.

1. While holding down the [FUNCTION] button, press in order two VOICE SELECT keys to turn on the Dual function.

2. Play the keyboard. You will hear the sound of two different voices layered together, just like two different instruments playing at the same time.

Notes:

1. The first voice key you've pressed will set the main voice, and the second key will set the dual voice.
2. When the Dual function is turned on, the Lower function will be disabled. To use the Lower function, you need to turn it on again.
3. When Dual and Lower functions are on, play the lower voice in the left hand area, and play the main and dual voices in the right hand area.

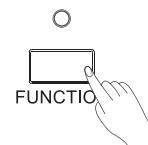
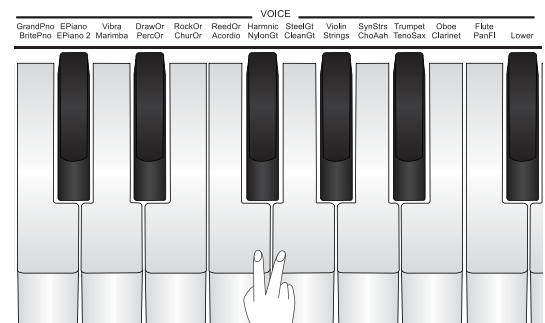
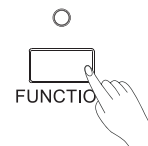

Playing Different Voices with Both Hands - LOWER

The Lower function splits the keyboard into the left and the right hand areas, each with a different voice. Play the lower voice in the left hand area. The split point is preset to #F3 (34).

1. While holding down the [FUNCTION] button, press the key marked Lower to turn on the Lower function.

Notes:

1. The lower voice is preset to be "String" voice, and not changeable.
2. It will disable the Lower function when Main voice or Dual voice function is on.

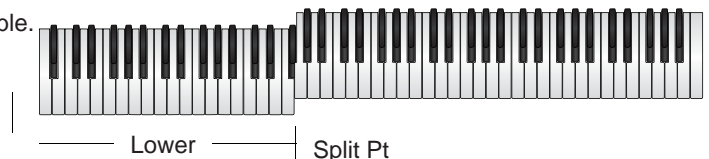
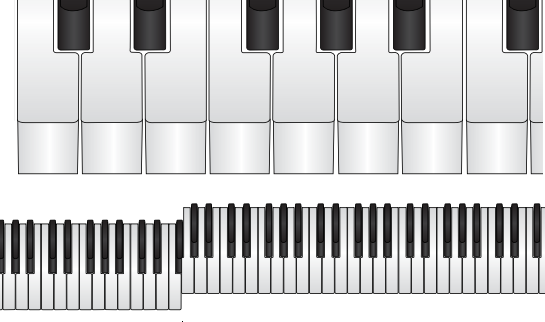
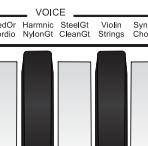

Playing Voice Demo

The instrument has 26 voice demos. Try playing them and enjoy the wonderful sound.

1. While holding down the [FUNCTION] button, press the VOICE DEMO key to start the demo playback of the selected main voice.
2. Repeat the operation to stop demo playback.

Notes:

In voice demo mode, all other keys on the keyboard will become invalid.

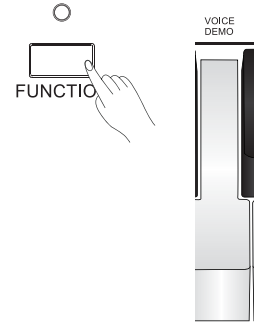

Touch Response

The keyboard is equipped with a touch response feature that allows you to control the level of the voice with your playing strength, just as on an acoustic piano.

While holding down the [FUNCTION] button, press one of the TOUCH keys to set the desired touch level.

While holding down the [FUNCTION] button, press one of the TOUCH keys to set the desired touch level.

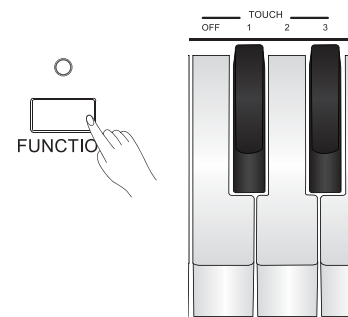

Parameters	Description
OFF	Fixed
1	Soft
2	Medium
3	Hard

The default type is: Medium

DSP Effects

Reverb and Chorus

While holding down the [FUNCTION] button, press one of the REVERB or CHORUS keys to select the desired reverb or chorus type.

Reverb Value:

Parameters	Description
OFF	OFF
1	Room
2	Small Hall
3	Large Hall
4	Stadium

The default type is: Small Hall

Chorus Value:

Parameters	Description
OFF	OFF
1	Light Chorus
2	Medium Chorus
3	Deep Chorus
4	Flanger

The default type is: OFF

EQ Effect

The EQ function controls the gain of different frequency band. And different gain settings will produce different sound field effects. The instrument has 3 EQ types as listed below.

While holding down the [FUNCTION] button, press one of the EQ keys to select the desired EQ type.

EQ Type:

Parameters	Description
1	Standard
2	Classical
3	Modern

The default type is: Standard

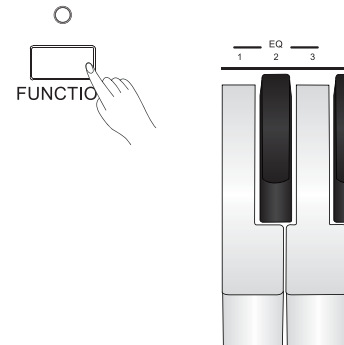
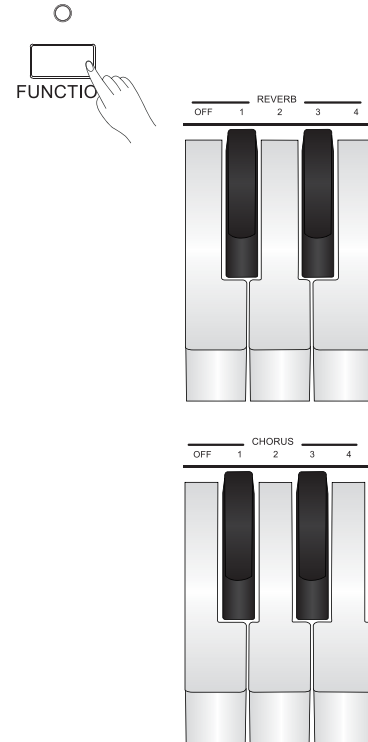

Metronome

Turn on the metronome:

While holding down the [FUNCTION] button, press METRONOME ON/OFF key to turn the metronome ON or OFF.

Select different time signature:

While holding down the [FUNCTION] button, press one of the METRONOME keys to select the desired time signature.

There are 6 types of time signature: 0, 2, 3, 4, 5, 6.

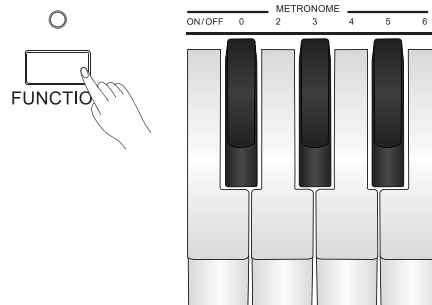

Tempo

While holding down the [FUNCTION] button, press one of the TEMPO keys to set the desired tempo value.

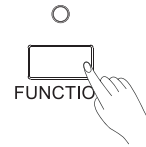

Parameters	Description
TAP	Quickly set the desired tempo value.
Tempo+/-	Increase/ Decrease tempo value by 1.
0 ~ 9	Directly set the specified tempo value.

Notes:

1. Press [tempo +] and [tempo –] keys simultaneously to set the tempo value back to the default (120).
2. Continuously tapping the [TAP] key at your desired tempo value, the piano will start the click sound at the tempo you tapped.

The piano will not recognize your tempo value if you tapped the [TAP] key less than the beats of current time signature, or the interval between each tapping is longer than 3 seconds.

However, the metronome will start at the speed of the last interval when you've tapped rightly equal to the current time signature.

The tempo value will be recognized as 30 when the speed is less than 30 or as 280 when the speed is higher than 280.

3. To set the tempo value with the number keys, you need to tap 3 keys. For example, tap 0, 8, 5 in sequence to set the tempo value to 85.

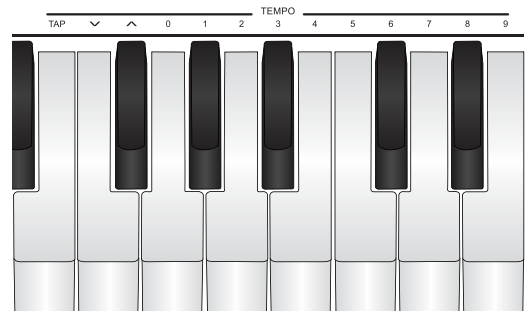

Beep Tone

While holding down the [FUNCTION] button, press beep key to turn the Beep Tone ON or OFF. The default setting is ON. If you turn on the beep tone, you can hear a beep sound when you press a valid functional key while the [FUNCTION] button is held down.

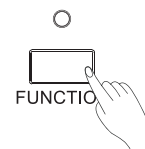

Troubleshooting

Problem	Possible Cause and Solution
The speakers produce a “pop” sound whenever the power is turned ON or OFF.	This is normal and is no cause for alarm.
No sound when the keyboard is played.	Make sure the voice volumes are set at appropriate levels. Check if headphones are plugged into Jack 2.
When using a mobile phone, noise is produced.	Using a mobile phone in close proximity to the instrument may produce interference. To prevent this, turn off the mobile phone or use it further away from the instrument.
After connecting with the computer, the piano is not recognized.	Please check if the USB cable is being connected firmly, or try to connect another USB port of the computer, without the need to install another driver on the PC.

Specifications

Keyboard

88 Hammer-Action Keys

Polyphony

128

Voice

26 panel voices

128GM voices

4 GM drum kits

Demo

1

Tempo

30 – 280

Control Button

Power On/Off switch, Volume, Function.

Control Key

Voice Select Keys, Voice Demo, Tempo Tap, Tempo +/-, Tempo Number Keys, Metronome On/Off, Metronome select keys, Reverb On/Off, Reverb Type Select Keys, Chorus On/Off, Chorus Type Select Keys, Touch On/Off, Touch Select Keys, EQ Type, Select Keys, Demo, Beep.

Connectors

Headphones (2 standard. ¼" phone), DC IN, AUX IN, AUX OUT, MIDI IN, MIDI OUT, USB, Pedals(Sustain, Soft, Sostenuto)

Power Supply

DC IN 15V 2500mA

Speaker

Woofer: 4ohm 25W x 2

Tweeter: 8ohm 20W x 2

Weight

51 KG

Dimensions

1398(W) x 750(D) x 790(H) mm

* All specifications and appearances are subject to change without notice.

Voice List

NO.	Full Name	Short Name
01	Acoustic Grand Piano	GrandPno
02	Bright Acoustic Piano	BritePno
03	Electric Piano	E.Piano
04	Electric Piano 2	E.Piano2
05	Vibraphone	Vibra
06	Marimba	Marimba
07	Drawbar Organ	DrawOrgn
08	Percussive Organ	PercOrgn
09	Rock Organ	RockOrgn
10	Church Organ	ChurOrgn
11	Reed Organ	ReedOrgn
12	Accordion	Acordion
13	Harmonica	Harmnica
14	Acoustic Guitar /nylon	NylonGtr
15	Acoustic Guitar /steel	SteelGtr
16	Electric Guitar /clean	CleanGtr
17	Violin	Violin
18	String Ensembles	Strings
19	Synth Strings	SynStrs
20	Choir Aahs	ChoirAah
21	Trumpet	Trumpet
22	Tenor Sax	TenorSax
23	Oboe	Oboe
24	Clarinet	Clarinet
25	Flute	Flute
26	Pan Flute	PanFlute

MIDI Implementation Chart

Function		Transmitted	Recognized	Remarks
Basic Channel	Default	1ch	ALL	
	Changed	16ch	1-16ch	
Mode	Default	x	3	
	Messages	x	3	
	Altered	*****	x	
Note Number	Note	0—127	0—127	
	:True voice	*****	0—127	
Velocity	Note on	o 9nH,V=1-127	o 9nH,V=1-127	
	Note off	o (9nH,V=0)	o(9nH,V=0; 8nH,V=0-127)	
After Touch	key's	x	x	
	Ch's	x	x	
Pitch Bend		o	o	
Control Change	0	o	o	Bank Select
	1	x	o	Modulation
	5	x	o	Portamento Time
	6	o	o	Data Entry
	7	o	o	Volume
	10	x	o	Pan
	11	x	o	Expression
	64	o	o	Sustain Pedal
	65	x	o	Portamento ON/OFF
	66	o	o	Sostenuto Pedal
	67	o	o	Soft Pedal
	80	x	o	Reverb Program
	81	x	o	Chorus Program
	91	o	o	Reverb Level
	93	o	o	Chorus Level
	120	x	o	All Sound Off
	121	x	o	Reset All Controllers
123	o	o	All Notes Off	
Program Change	:true	*****	0—127	
System Exclusive		x	o	
System Common	:SongPosition	x	x	
	:Song Select	x	x	
	:Tune	x	x	
System Real Time	:Clock	o	x	
	:Commands	x *1	x *1	
Aux Message	: LOCAL ON/OFF	x	x	
	: All Notes Off	o	o	
	: Active sense	o	o	
	: Reset	x	o	
Notes: *1 When the accompaniment is started, an FAH message is transmitted. When accompaniment is stopped, an FCH message is transmitted.				

- Mode 1: OMNI ON, POLY
- Mode 2: OMNI ON, MONO

- Mode 3: OMNI OFF, POLY
- Mode 4: OMNI OFF, MONO

- o: YES
- x: NO

